

DIMENSIONS & RECOMMENDED PATTERN

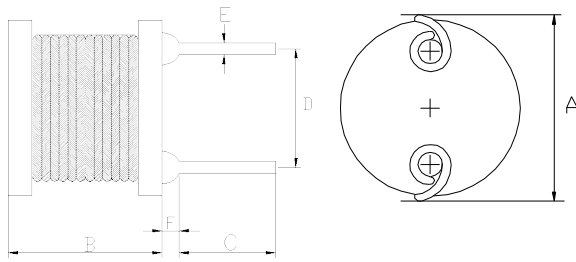

A: 16.5 Max.	mm
B: 15.5 Max.	mm
C: 15.0±2.0	mm
D: 7.5±0.5	mm
E: φ1.0±0.1	mm
F: 3.0 Max.	mm

※FEATURE

Applications:DC-DC converters,LCD Set,OA equipment,notebook, PDA

SELECTION GUIDE FOR STANDARD COILS:

MAGLAYERS PT/NO.	Inductance L(μH)	Percent Tolerance	Test Frequency	Resistance RDC(Ω)Max.	Rated DC Current
					IDC1(A)
GDR-1415-100□	10	M	100kHz/0.25V	17 m	14.0
GDR-1415-120□	12	K,M	100kHz/0.25V	19 m	12.0
GDR-1415-150□	15	K,M	100kHz/0.25V	21 m	10.0
GDR-1415-220□	22	K,M	100kHz/0.25V	26 m	8.8
GDR-1415-270□	27	K,M	100kHz/0.25V	28 m	8.3
GDR-1415-330□	33	K,M	100kHz/0.25V	34 m	7.8
GDR-1415-390□	39	K,M	100kHz/0.25V	38 m	7.3
GDR-1415-470□	47	K,M	100kHz/0.25V	46 m	6.7
GDR-1415-560□	56	K,M	100kHz/0.25V	51 m	6.2
GDR-1415-680□	68	K,M	100kHz/0.25V	55 m	5.7
GDR-1415-820□	82	K,M	100kHz/0.25V	58 m	5.2
GDR-1415-101□	100	K,M	100kHz/0.25V	75 m	4.6
GDR-1415-121□	120	K,M	100kHz/0.25V	0.100	4.2
GDR-1415-151□	150	K,M	100kHz/0.25V	0.125	3.7
GDR-1415-181□	180	K,M	100kHz/0.25V	0.141	3.5
GDR-1415-221□	220	K,M	100kHz/0.25V	0.208	3.0
GDR-1415-271□	270	K,M	100kHz/0.25V	0.240	2.7
GDR-1415-331□	330	K,M	100kHz/0.25V	0.272	2.5
GDR-1415-391□	390	K,M	100kHz/0.25V	0.303	2.3
GDR-1415-471□	470	K,M	100kHz/0.25V	0.342	2.1
GDR-1415-561□	560	K,M	100kHz/0.25V	0.531	1.8
GDR-1415-681□	680	K,M	100kHz/0.25V	0.590	1.7
GDR-1415-821□	820	K,M	100kHz/0.25V	0.728	1.5
GDR-1415-102□	1000	J,K,M	100kHz/0.25V	0.750	1.4

※GENERAL SPECIFICATION:

※ 1. □ specify the inductance tolerance, J(±5%)K(±10%),M(±20%)

※ 2. IDC1 : Based on inductance change ($\Delta L/L_0$: drop10% Max.) @ ambient temp. 25°C

IDC2 : Based on temperature rise (ΔT : 40°C TYP.) Rated

DC Current : The less value which is IDC1 or IDC2.